



**YANMAR**

AIR-COOLED DIESEL ENGINES

# ***L-N / L-V / L-W Series***

3.5 kW [4.7 HP] – 6.8 kW [9.3 HP]



# AIR-COOLED DIESEL ENGINE

Since 1959, YANMAR has been producing a wide range of compact air-cooled diesel engines ranging in size from 2.6 to 14.7 kW, with total production reaching more than 1.5 million units. Today, these air-cooled diesel engines are powering leading-edge mobile and stationary off-highway equipment around the world.



## L-N Series

- L48N** 3.5kW [4.7hp]
- L70N** 4.9kW [6.7hp]
- L100N** 7.4kW [10.0hp]

### MAIN MARKETS

- E.U.
- Southeast Asia
- Middle East
- Africa

## History



### A / 2A Series 2.6 - 13.2kW 8 models



Main model : A3  
 Combustion system : Special swirl chamber type  
 Displacement : 0.239L  
 No. of Cylinders - Bore x Stroke : 1 -  $\Phi$ 65mm x 72mm  
 Rated Output : 3.3kW / 3000min<sup>-1</sup>  
 Engine Weight : 49kg

### L / 2L Series 2.6 - 14.7kW 8 models



Main model : L65  
 Combustion system : Pre-combustion chamber type  
 Displacement : 0.238L  
 No. of Cylinders - Bore x Stroke : 1 -  $\Phi$ 65mm x 72mm  
 Rated Output : 3.3kW / 3000min<sup>-1</sup>  
 Engine Weight : 46kg

### L-A / L-EE Series 2.6 - 7.4kW 12 models



Main model : L60A  
 Combustion system : Direct injection type  
 Displacement : 0.273L  
 No. of Cylinders - Bore x Stroke : 1 -  $\Phi$ 75mm x 62mm  
 Rated Output : 4.4kW / 3600min<sup>-1</sup>  
 Engine Weight : 39kg





### **L-V Series**

**L70V** 4.8kW [6.5hp]  
**L100V** 6.8kW [9.3hp]

**MAIN MARKETS**

- E.U.
- Japan



### **L-W Series**

**L70W** 4.8kW [6.5hp]  
**L100W** 6.8kW [9.3hp]

**MAIN MARKET**

- U.S.A.

# Exceeding Power and Environmental Expectations.

Designed with YANMAR's proprietary direct injection technology, maximum combustion efficiency is achieved through an ideal match between the combustion chamber and injection system. This means a powerful, yet environmentally friendly engine.





## **Compact, Direct Injection Engine = Easy Installation & Low Fuel Consumption**

Keeping with the traditional compact design, the L series engines are simple to install by fitting into cramped spaces without sacrificing power and performance. YANMAR's proprietary direct injection technology allows the engine to sip rather than gorge on fuel, which means lower running costs in the world of rising fuel prices.

## **Quick, Easy Starting With Standard Recoil**

A special auto-return decompressor and YANMAR's own efficient combustion system breeze through starting with electric starting also offered as an option.

## **Low Vibration and Noise**

Superior vibration and noise reduction is achieved through the use of precision balancers, which leads to operating comfort even during long work hours.

## **The Total FIE Expertise Only a Complete Diesel Engine Manufacturer Can Provide**

YANMAR developed one of the world's smallest fuel injection systems. We have since raised it to a level of efficiency that ensures maximum power from every drop of diesel. Its extraordinarily low fuel consumption is a result of our super-precise FIE, and our direct injection system, the first to ever go into this type of engine.



# AIR-COOLED DIESEL ENGINE

# L-N Series

For regions not subject to emissions regulations

Notes :

- As of 2016
- For information about applications and each country's regulations, please contact your local YANMAR sales network.



## L48N

Rated Output (Gross)

# 3.5kW

## [4.7hp]

/3600min<sup>-1</sup>



PERFORMANCE CURVES L48N5

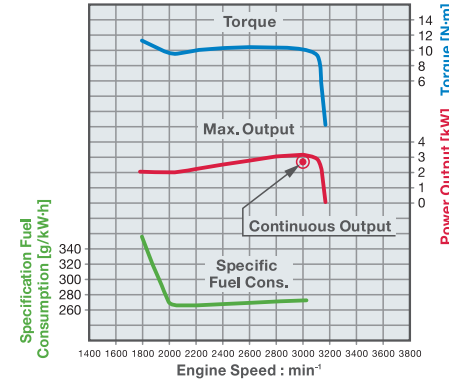

PERFORMANCE CURVES L48N6

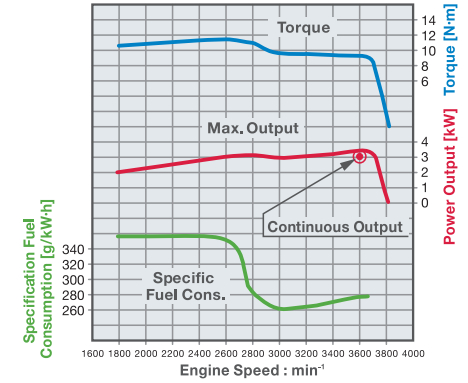

\* Note: Performance based on the following conditions.

### DIMENSIONS

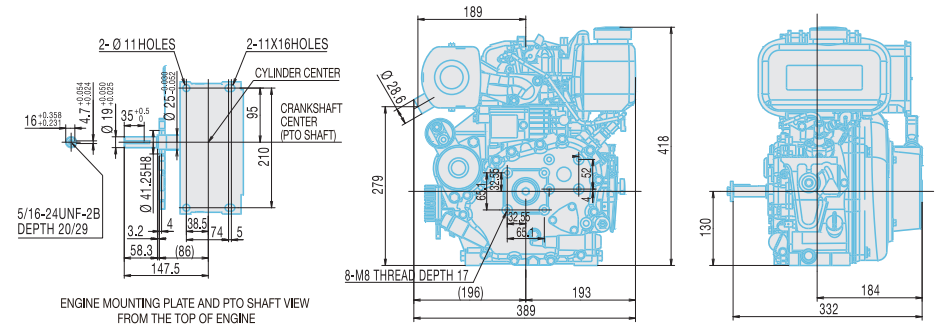



# L70N

Rated Output (Gross)

## 4.9kW

### [6.7hp]

/3600min<sup>-1</sup>



PERFORMANCE CURVES L70N5

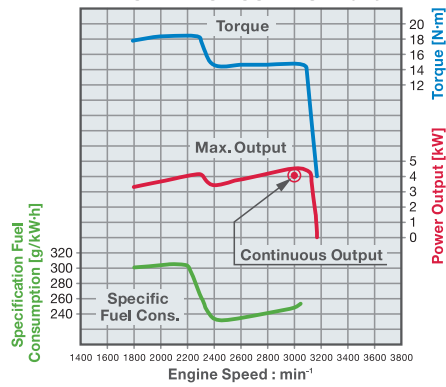

PERFORMANCE CURVES L70N6

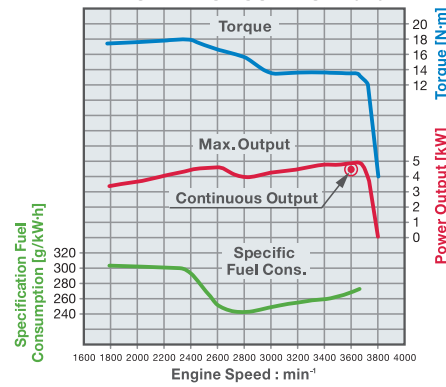

\* Note: Performance based on the following conditions.

## DIMENSIONS

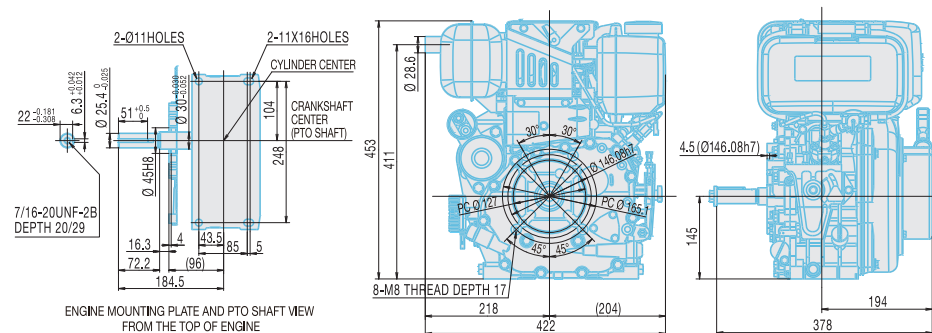

# L100N

Rated Output (Gross)

## 7.4kW

### [10.0hp]

/3600min<sup>-1</sup>



PERFORMANCE CURVES L100N5

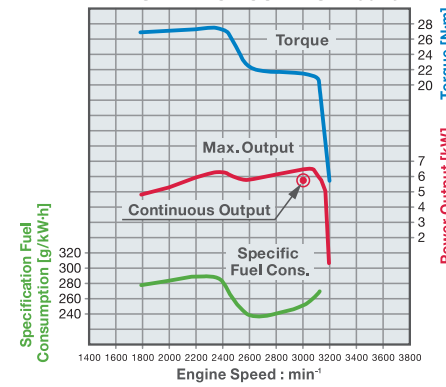

PERFORMANCE CURVES L100N6

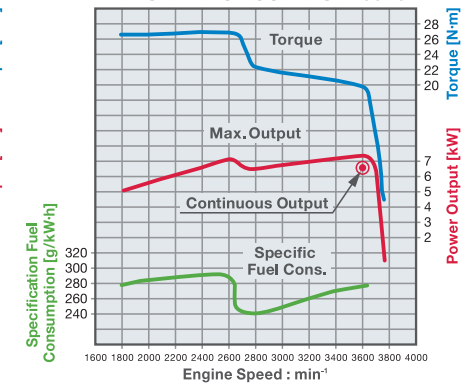

\* Note: Performance based on the following conditions.

## DIMENSIONS

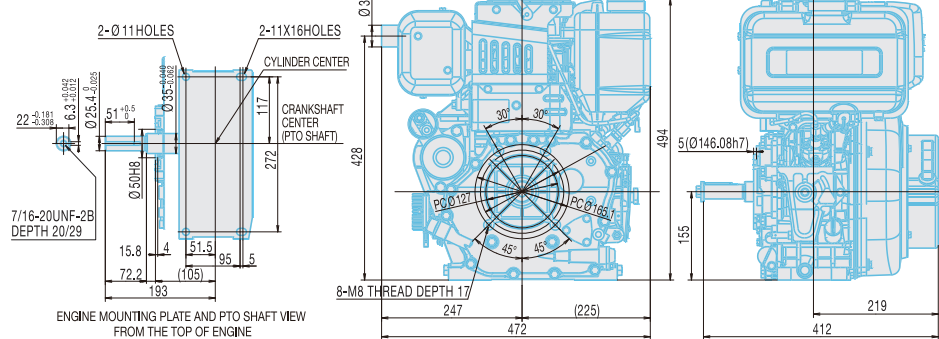

\* • After 30 hrs. initial running • Atmospheric conditions: Temperature 298K(25° C) / Pressure 100kPa (750mmHg) / Humidity 30%

# AIR-COOLED DIESEL ENGINE

# L-V Series

## EPA Tier 4 Equivalent

Notes :

- As of 2016
- For information about applications and each country's regulations, please contact your local YANMAR sales network.

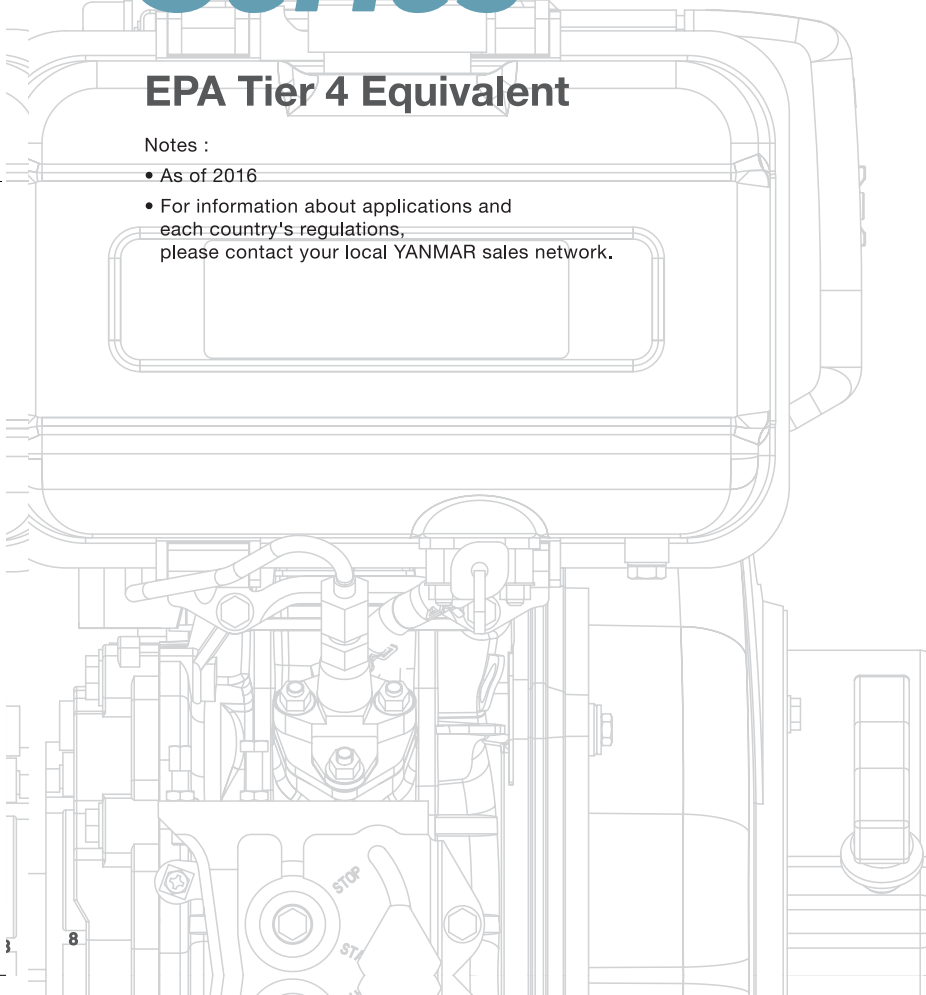

# L70V

Rated Output (Gross)

**4.8kW**  
[6.5hp]  
/3600min<sup>-1</sup>



PERFORMANCE CURVES L70V5

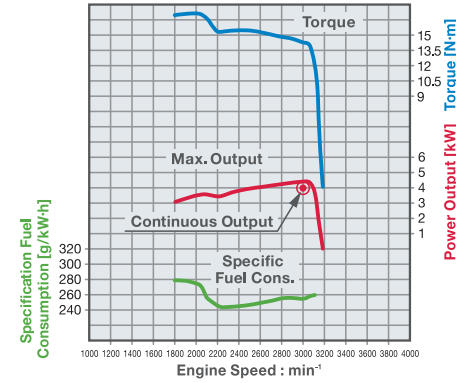

PERFORMANCE CURVES L70V6

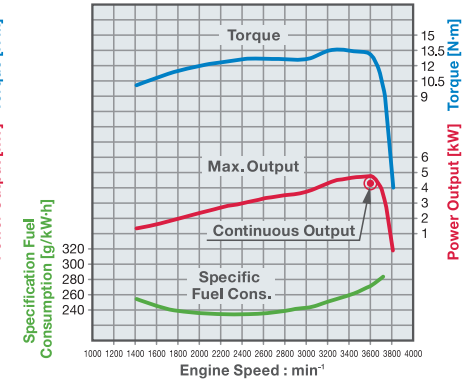

\* Note: Performance based on the following conditions.

## DIMENSIONS

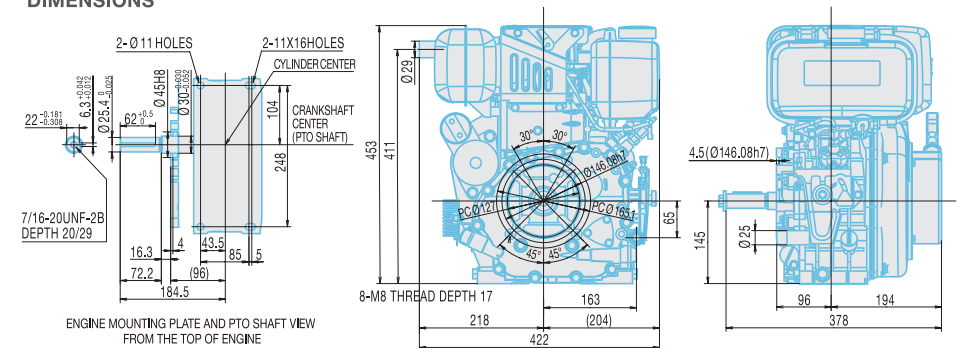





# AIR-COOLED DIESEL ENGINE

# L-W Series

## EPA Tier 4 Final Equivalent

Notes :

- As of 2016
- For information about applications and each country's regulations, please contact your local YANMAR sales network.

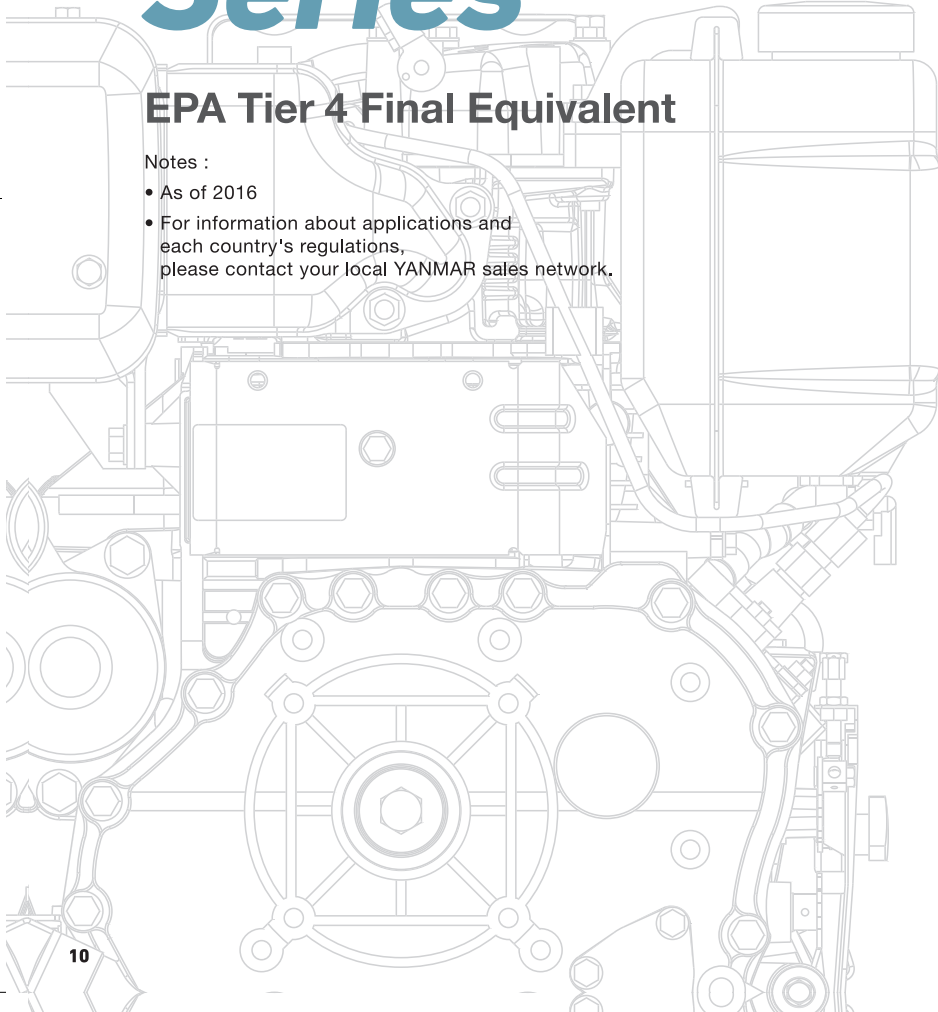

# L70W

Rated Output (Gross)

**4.8kW**  
[6.5hp]  
/3600min<sup>-1</sup>



PERFORMANCE CURVES L70W6

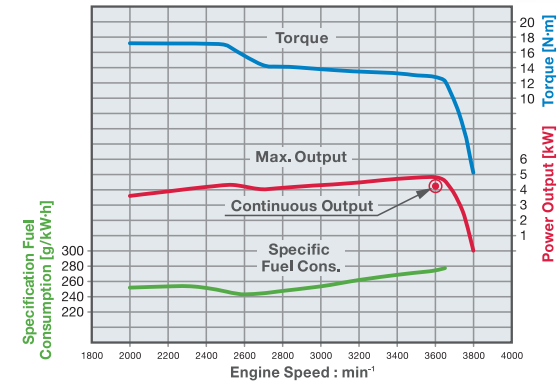

\* Note: Performance based on the following conditions.

## DIMENSIONS

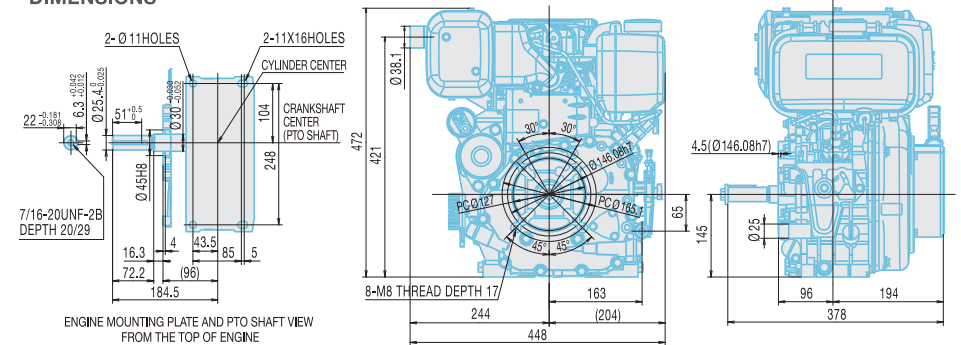



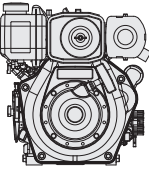
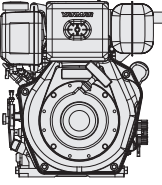
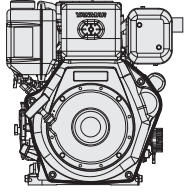
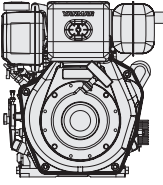
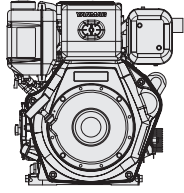
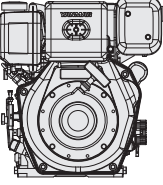
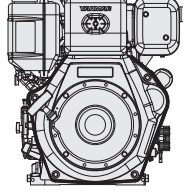

# Engine Specifications

Engine Series			L-N Series					L-V Series				L-W Series		
Engine Model			L48N	L70N		L100N		L70V	L100V		L70W	L100W		
														
Type			4 stroke, vertical cylinder, air-cooled diesel engine											
No. of Cylinders			1											
Bore x Stroke			mm		Φ70 x 57		Φ78 x 67		Φ86 x 75		Φ78 x 67		Φ86 x 75	
Displacement			liter		0.219		0.320		0.435		0.320		0.435	
Continuous Rated Output	Engine Speed	rpm(min <sup>-1</sup> )	3600	3000	3600	3000	3600	3000	3600	3000	3600	3000	3600	3600
	Output	kW[hp]	3.1[4.2]	2.8[3.8]	4.4[6.0]	4.1[5.5]	6.6[9.0]	5.7[7.7]	4.3[5.9]	4.0[5.4]	6.2[8.4]	5.7[7.7]	4.3[5.9]	6.2[8.4]
Maximum Rated Output	Engine Speed	rpm(min <sup>-1</sup> )	3600	3000	3600	3000	3600	3000	3600	3000	3600	3000	3600	3600
	Output / Eng. Speed	kW[hp]	3.5[4.7]	3.1[4.2]	4.9[6.7]	4.5[6.1]	7.4[10.0]	6.5[8.8]	4.8[6.5]	4.4[6.0]	6.8[9.3]	6.3[8.5]	4.8[6.5]	6.8[9.3]
High Idling			rpm(min <sup>-1</sup> )		3800±30	3175±30	3800±30	3175±30	3800±30	3175±30	3800±30	3175±30	3800±30	3800±30
Engine Weight (Dry)	Electric Starter	kg	32.0		41.0		53.5		41.0		53.5		43.0	53.5
	Recoil Start	kg	27.0		36.0		48.5		36.0		48.5		38.0	48.5
Cooling System			Forced air-cooling by flywheel fan											
Lubricating System			Forced lubricating system											
Starting System			Electric start / Recoil start											
Dimension	Overall Length (L)	mm	332		378		412		378		412		395	429
	Overall Width (W)	mm	384		422		472		422		472		448	472
	Overall Height (H)	mm	417		453		494		453		494		472	494
Lubricating System	Dispstick Upper Limit	liter	0.8		1.1		1.6		1.1		1.6		1.1	1.6
	Dispstick Lower Limit	liter	0.6		0.7		1.0		0.7		1.0		0.7	1.0
Fuel Oil Tank Capacity			liter		2.4		3.3		5.4		3.3		5.4	

Note : Specifications are subject to change depending on the engine parts and optional kits selected.

# Accessories

○ = Standard  
△ = Option

Engine Series		L-N Series									L-V Series								L-W Series							
Engine Model		L48N			L70N			L100N			L70V				L100V				L70W				L100W			
Category *		G	GE	P	G	GE	P	G	GE	P	G	GE	P	V	G	GE	P	V	G	GE	P	V	G	GE	P	V
Fuel system	Fuel tank (2.4 liter)	○	○	○																						
	Fuel tank (3.3 liter)				○	○	○				○	○	○	○					○	○	○	○				
	Fuel tank (5.4 liter)							○	○	○					○	○	○	○					○	○	○	○
	w/o Fuel tank	△	△	△	△	△	△	△	△	△	△	△	△	△	△	△	△	△	△	△	△	△	△	△	△	△
Starting system	Starting motor (w/Recoil starter)	○	○	○	○	○	○	○	○	○	○	○	○	○	○	○	○	○	○	○	○	○	○	○	○	
	Recoil starter	△	△	△	△	△	△	△	△	△	△	△	△	△	△	△	△	△	△	△	△	△	△	△	△	
	Key switch	○	○	○	○	○	○	○	○	○	○	○	△	○	○	○	△	○	○	○	△	○	○	○	△	
	w/o Key switch	△	△	△	△	△	△	△	△	△	△	△	○	△	△	△	○	△	△	△	○	△	△	△	○	
Electric system	Charging dynamo (12V-15A)	○	○	○	○	○	○	○	○	○	○	○	○	○	○	○	○	○	○	○	○	○	○	○	○	
	Charging dynamo (12V-1A)	△	△	△	△	△	△	△	△	△	△	△	△	△	△	△	△	△	△	△	△	△	△	△	△	
	w/o Charging dynamo	△	△	△	△	△	△	△	△	△	△	△	△	△	△	△	△	△	△	△	△	△	△	△	△	
PTO system	Straight (E-D)	○			○			○			○			△	○			△	○			△	○		△	
	Straight (D)	△			△			△			△			○	△			○	△			○	△		○	
	Taper (E-DG)		○			○			○			○				○			○				○			
	Taper (DG)		△			△			△			△				△			△				△			
	Taper (E-DI)		△			△			△			△				△			△				△			
	Thread (E-DP)			○			○			○			○				○				○			○		
	Thread (DP)			△			△						△							△						
Speed control device	General use (by remote & hand)	○	△	△	○	△	△	○	△	△	○	△	△	△	○	△	△	△	○	△	△	△	○	△	△	
	Constant speed type (by hand)	△	○	△	△	○	△	△	○	△	△	○	△	△	△	○	△	△	△	○	△	△	△	○	△	
	Friction plate type (by hand)	△	△	○	△	△	○	△	△	○	△	△	○	△	△	○	△	△	△	○	△	△	△	○	△	
	Remote control type	△	△	△	△	△	△	△	△	△	△	△	○	△	△	△	○	△	△	△	○	△	△	△	○	
Maintenance tools	○	○	○	○	○	○	○	○	○	○	○	○	○	○	○	○	○	○	○	○	○	○	○	○	○	

\* : G = General / GE = Generator / P = Pump / V = V-machine  
Note: For other accessories, please contact your YANMAR sales network.

# PTO Dimensions

**L48N**

# 48

**L70N  
L70V  
L70W**

# 70

**L100N  
L100V  
L100W**

# 100

Keyway shaft

Taper shaft

Application code

**E-D**

**D**

**E-DG**

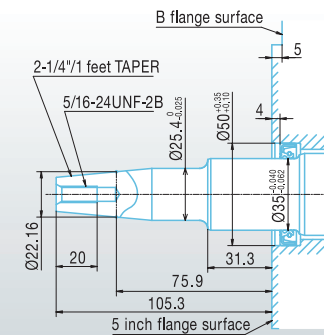
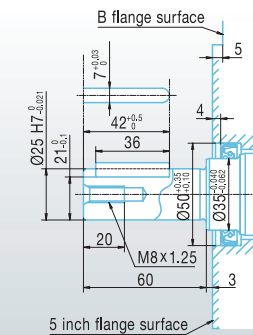
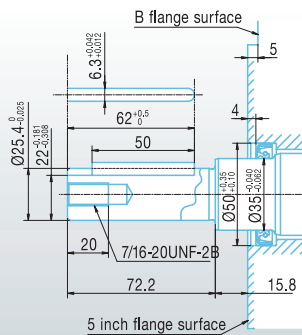
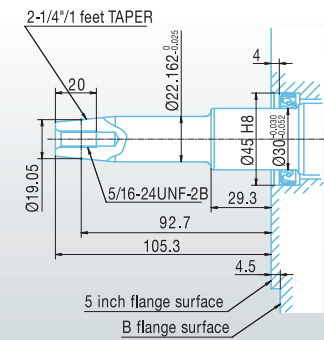
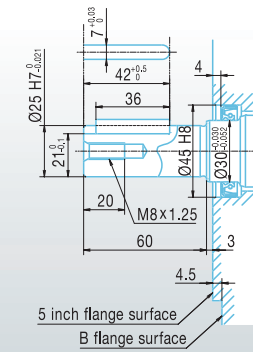
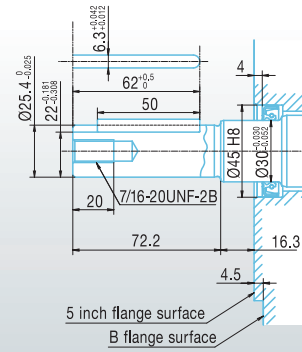
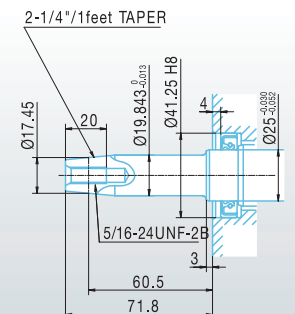
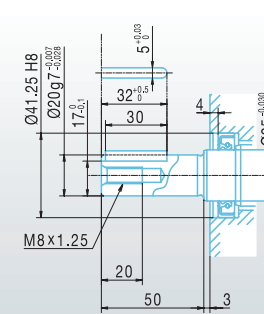
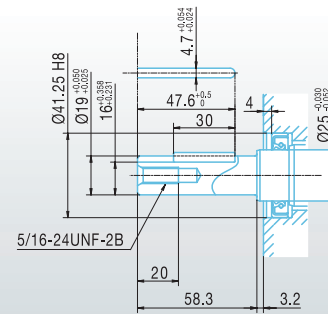



DG	E-DI	E-DP	DP	PTO Flanges
<p>5 inch flange surface B flange surface</p>	<p>5 inch flange surface B flange surface</p>	<p>5 inch flange surface B flange surface</p>	<p>5 inch flange surface B flange surface</p>	
<p>B flange surface</p>	<p>B flange surface</p>	<p>B flange surface</p>		



**Head Office**

Yanmar Co., Ltd  
YANMAR FLYING-Y BUILDING  
1-32 Chayamachi, Kita-ku,  
530-8311 Osaka, Japan  
[www.yanmar.com](http://www.yanmar.com)

**Regional Office / Sales & Service**

Yanmar Europe B.V.  
Brugplein 11, 1332 BS Almere, The Netherlands  
T: +31 [0]36 549 3200  
F: +31 [0]36 549 3209  
E: [industrial-yeu@yanmar.com](mailto:industrial-yeu@yanmar.com)  
[www.yanmar.eu](http://www.yanmar.eu)